

# QUEEN'S WHARF BRISBANE



## Queen's Wharf Brisbane

### Invigorating our heritage

**Queen's Wharf Brisbane is recognised as the birthplace of Brisbane's European history, it has one of the greatest collections of culturally significant heritage buildings and places in Australia, dating back to the early 1800s.**



The precinct is situated in the heart of the city's CBD, between the Brisbane River and George Street, and extends from Alice Street to Queen Street.

While many of the buildings, streets, and parks remain, some of the heritage buildings are inaccessible to the general public. As part of Destination Brisbane Consortium's multi-billion dollar Queen's Wharf Brisbane integrated resort development, all of the precinct's heritage buildings and places will be repurposed and reactivated for public use.

By sensitively revitalising these 'jewels' of the precinct, locals and visitors alike will have the unique chance to explore both the Aboriginal and European history of Brisbane through a variety of food and beverage, tourism, and retail experiences, which will breathe new life into a largely underutilised part of the city. New heritage trails through the precinct are also proposed to incorporate both Aboriginal and European history as part of the integrated resort development.





# Heritage buildings and places within the precinct

## 1 The former Treasury Building

21 Queen Street

**Currently:** The Treasury Casino.

**Proposed:** A high-end retail offering and part of The Ritz-Carlton Hotel.

## 2 Queen's Gardens (also known as Queens Park)

144 George Street

**Currently:** A public park.

**Proposed:** Rejuvenated public park.

## 3 The former Land Administration Building

142 William Street

**Currently:** The Treasury Hotel.

**Proposed:** The Ritz-Carlton Hotel including fine dining restaurant and bar.

## 4 The former Government Printery

110 George Street

**Currently:** Registry of Births, Deaths, and Marriages.

**Proposed:** Mixed food and beverage and boutique retail outlets.

## 5 Harris Terrace

68 George Street

**Currently:** Mixed commercial use.

**Proposed:** Fresh food markets and outdoor dining in the courtyard.

## 6 The Mansions

40 George Street

**Currently:** General office accommodation; a restaurant.

**Proposed:** Premium food and beverage experiences in The Mansions and Mansions Lane; and mixed food and beverage experiences in Mansions Plaza (to be built).

## 7 The Printery Office

84 William Street

**Currently:** The Consortium's project office.

**Proposed:** Cooking school, and food and beverage training facility.

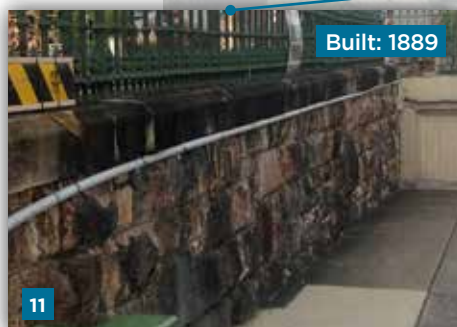
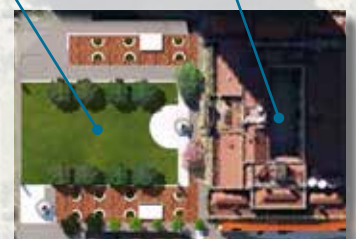



## 8 The former Department of Primary Industries building

95 William Street

**Currently:** The National Trust of Australia (Queensland) headquarters.

**Proposed:** Mixed food and beverage experiences including a micro-brewery.

## 9 The Commissariat Store Museum and Miller Park

115-127 William Street

**Currently:** The Royal Historical Society of Queensland (RHSQ) headquarters; a public park.

**Proposed:** RHSQ will remain in the building. Miller Park will be revitalised to provide landscape terraces for access to water; an informal amphitheatre for events and entertainment; and links to the Aboriginal and European Heritage Centre.

## 10 The former State Library Building

159 William Street

**Currently:** The Star Entertainment Group's Brisbane office.

**Proposed:** An Aboriginal and European Heritage Centre featuring tourist information and interactive exhibits. The National Trust of Australia will also operate from this location.

## 11 William Street and Queens Wharf Road (heritage-listed retaining walls)

*William Street; and Queens Wharf Road near its intersection with Queen Street*

**Currently:** Historical features showcasing the development of infrastructure in Brisbane.

**Proposed:** 'Undercurrent Village' – A series of connected performance spaces that enable events, pop-up stalls, and bike pathways that will feature along with the walls at the river's edge.







## PROJECT TIMELINE

2017-2018	2019-2020	2021	2022	2023	2024
<b>Demolition, excavation and shoring works</b> <ul style="list-style-type: none"> <li>Brace heritage buildings as required and install monitoring equipment</li> <li>Demolition of non-heritage buildings</li> <li>Excavation of integrated resort basement</li> <li>Shoring of basement perimeter</li> </ul>	<b>Construction</b> <ul style="list-style-type: none"> <li>Commencement of foundation and car park</li> <li>Opened Waterline Park and upgraded Bicentennial Bikeway</li> <li>Core development starts to take shape as construction progresses above ground</li> <li>Neville Bonner Bridge construction commences</li> </ul>	<ul style="list-style-type: none"> <li>Core of development is continuing to progress skyward</li> <li>Fit out of the basement and podium level commences</li> <li>Work is commencing on the redevelopment of the section of Bicentennial Bikeway from North Quay to Waterline Park</li> <li>Landscaping works on The Landing commence</li> </ul>	<ul style="list-style-type: none"> <li>Core of development reaches full height on the three hotel towers</li> <li>Sky Deck is constructed and lifted into position</li> <li>Fit-out of the hotel towers commence</li> <li>Neville Bonner Bridge structure installed</li> </ul>	<b>Opening</b> <ul style="list-style-type: none"> <li>Opening of integrated resort development, including hotels, restaurants and public realm areas</li> <li>Neville Bonner Bridge completed and opened</li> <li>T Galleria at the Printery heritage building opened</li> <li>Queen's Wharf Residences completed</li> <li>Bicentennial bikeway upgrade works completed</li> </ul>	<ul style="list-style-type: none"> <li>Transformation and staged opening of various heritage buildings throughout the precinct</li> </ul>

## About Destination Brisbane Consortium

Destination Brisbane Consortium will deliver a world-class integrated resort and entertainment precinct to Brisbane and Queensland and Queensland, which is expected to open in 2022. The consortium involves three major partners: The Star Entertainment Group, Chow Tai Fook Enterprises, and Far East Consortium.



For more information visit:

**[www.queenswharfbrisbane.com.au](http://www.queenswharfbrisbane.com.au)**

or come see us at:

**Queen's Wharf  
Brisbane Visitor Centre**

Corner of Alice and  
George Streets

**Destination Brisbane  
Consortium**

PO Box 13226  
George Street  
Brisbane Q 4003

1800 104 535

QWBenquiries@  
destinationbrisbane.com.au

facebook.com/  
queenswharfbrisbane

© Destination Brisbane Consortium. All rights reserved. All images are artist's impressions. Subject to planning approvals.

